



The Hon. Speaker.

REPUBLIC OF NAURU

Government Gazette

Published by Authority

No. 53

4th December, 1972

Nauru

G.N. No. 334/1972

BIRTHS, DEATHS & MARRIAGES ORDINANCE 1956 - 1966

Births, deaths and marriages registered during week ended 1st December, 1972 were:-

BIRTHS

1. NAURUAN

<u>Name</u>	<u>Date of Birth</u>	<u>Sex</u>	<u>Reg'd Dist.</u>	<u>Tribe</u>
Myjorae Marlena Halstead	4/11/1972	F	Buada	Eamwit
Joel Stephanus Adimo Udire	14/10/1972	M	Yaren	Emea

2. O.P.I.

Buriburi Kaeta	22/11/1972	N.P.C. Location
Tiuea Ioane	22/11/1972	N.P.C. Location

DEATHS

O.P.I.

<u>Name</u>	<u>Date of Death</u>	<u>Sex</u>	<u>Age</u>	<u>Reg'd Dist.</u>	<u>Tribe</u>
Tangira Tamaere	19/11/1972	F	32 yrs	N.P.C. Location.	

MARRIAGES

Samuel Robinen Billeam of Aiwo District, and Valencia Emin Jeremiah of Meneng District on 18th November, 1972 by the Rev. Itubwa Amram, at Orro Central Church, Nauru.

Lanza Detabaunun Adam of Boe District, and Eileen Patricia Kiki also of Boe District, on 17th November, 1972 by the Rev. Itubwa Amram, at Orro Central Church, Nauru.

Palik Agir of Aiwo District, and Melinda Eidawuro Detageauwa of Nibok District, on 17th November, 1972 by the Rev. Itubwa Amram, at Orro Central Church, Nauru.

H.B. CONNELL,

REGISTRAR

BIRTHS DEATHS & MARRIAGES.

G.N. No. 335/1972

ENGAGEMENT TO MARRY

Name of Party:

RUTHVEN IKELANI REYNOLD CAPELLE of Boe and MERLYN EROUBINA DETABENE of Buada Districts.

Date of Engagement:

27th November, 1972.

A. BERNICKE,
SECRETARY.

LAND DETERMINATION

The Nauru Lands Committee hereby determines the ownership of certain land or shares in land as being that shown below:-

District	Portion No.	C.L. P.L.	Name of Land	Reference	Former Owners	Shares	Present Owners in equal shares
----------	-------------	--------------	--------------	-----------	---------------	--------	-----------------------------------

CORRIGENDUM

It is notified for general information that the Nauru Lands Committee's determination in respect of the lands "ARUWONGADA" Portion 127 and "BOTIBAB" Portion 126 published in G.N. No. 97/1971 of Government Gazette No. 17 of 1971 is hereby amended.

DELETE

ANETAN	" 127	PL	ARUWONGADA	DAIMON EST. FILE	ALL	RENZO PAUL	ALL
--------	-------	----	------------	---------------------	-----	------------	-----

INSERT

ANETAN	127	"	PL	BOTIBAB	R.B. PAGE 212 BOOK 1929 EST. FILE - DEKEKA.	DEKEKA 1/2 DEGOROGORE 1/2	DEGOREGORE 1/2 BIRIBIRINANG DICK 1/8 JUANITA EMEAE DICK 1/8 ANTHONY DETSIMEA 1/8 JOSEPH DETSIMEA 1/8
--------	-----	---	----	---------	---	------------------------------	--

CANCELLATION

ANETAN	126		PL	BOTIBAB	EST. FILE - DEKAKA. R.B. PAGE 212	DEKEKA 1/2 DEGOROGORE 1/2	DEGOROGORE 1/2 BIRIBIRINANG DICK 1/8 JUANITA EMEAE DICK 1/8 ANTHONY DETSIMEA 1/8 JOSEPH DETSIMEA 1/8
--------	-----	--	----	---------	--	------------------------------	--

Any person who wishes to appeal against the amendment of Portions 126 and 127 must lodge his or her appeal with Supreme Court Registry within 21 days of this Gazette and no appeal may be commenced after that time.

Dated this 30th day of November, 1972.

JEREMIA,
SECRETARY.

LAND DETERMINATION

The Nauru Lands Committee hereby determines the ownership of certain land or shares in land as being that shown below:-

District	Portion No.	C.L. P.L.	Name of Land	Reference	Former Owners	Shares	Present Owners in equal shares
----------	-------------	--------------	--------------	-----------	---------------	--------	-----------------------------------

SUPREME COURT'S ORDER
IN LAND CASE NO. 16 OF 1972
ROY DEGOROGORE & OTHERS
VERSUS

1. DOGIREIJ ADUN & OTHERS
2. EIDUBWA KEPAE & OTHERS

It is notified that the following amendments are effected to Government Gazette No. 28 of 26th June, 1972, G.N. No. 193/1972 page 14.

DELETE

ANETAN	21	PL	IYEIDA	R.B. PAGE 202	GANIA	ALL	DOGIREIJ ADUN PRISCILLA D. AQUILLA B. MARY L. LUDWIG D. RANDOLPH D. ORIANA D. ESTELLA A. RINGO A. MARLENE A. DOUBA S. (LTO)	1/2 1/20 1/20 1/20 1/20 1/20 1/20 1/20 1/20 1/20 1/20
--------	----	----	--------	------------------	-------	-----	---	---

INSERT

ANETAN	21	PL	BOTIBAB	R.B. OR PAGE 202 IYEIDA DISP. 1929	DEKEKA DEGOROGORE	1/2 1/2	DEGOROGORE ADIADOBWE	1/4 1/4
--------	----	----	---------	--	----------------------	------------	-------------------------	------------

JEREMIA,
SECRETARY.

No. 53
G.N. No. 338/1972

4th December, 1972

Nauru

DECEASED ESTATES

The Nauru Lands Committee, having made all due enquiries hereby determines the following Deceased Estates and phosphate royalties as appears below.

District	Port No.	C.L. P.L.	Name of Land	Former Owner	Shares	Gaz. No.	Land Vol.	Record Folio.	Royalties	N.P.C. No.	Admin. No.	Present Owners in equal shares
Aiwo	456	PL	Eateibogoade	Itsimaera (dec'd (LTO)	1/36	36/68	15	210	-	-	-	Dugia Rubenit Dekarube 1/288 Eidiobobwe Gadangauwa 1/288 Jerry Itsimaera 1/288 Alf Itsimaera 1/288 Eideraibobwe Itsimaera 1/288 Eidowonok Bam 1/288 Tsime de Itsimaera 1/288 Clarinda Daniel 1/288
Nibok	80	PL	Ati	"	1/135	36/68	12	80	-	778 1055	1214 1494	As for Portion 456 (Aiwo) with 1/1080th share each.
Nibok	181	CL	Anobobwija	"	1/9	36/68	12	182	-	-	-	Dugia Rubenit 1/72 Eidiobobwe Gadangauwa 1/72 Jerry Itsimaera 1/72 Alf Itsimaera 1/72 Eideraibobwe Itsimaera 1/72 Eidowonok Bam 1/72 Tsime de Itsimaera 1/72 Clarinda Daniel 1/72
Nibok	236	CL	Ati	"	1/9	36/68	12	237	-	-	-	As for Portion 181 (Nibok)
Nibok	79	PL	Amero	"	1/45	36/68	12	79	-	777 863	1213 1302	Dugia Rubenit Dekarube 1/360 Eidiobobwe Gadangauwa 1/360 Jerry Itsimaera 1/360 Alf Itsimaera 1/360 Eideraibobwe Itsimaera 1/360 Eidowonok Bam 1/360 Tsime de Itsimaera 1/360 Clarinda Daniel 1/360
Nibok	98	PL	Eamen	"	1/45	36/68	12	99	-	868 1306	1307 1748	As for Portion 79 (Nibok)
Nibok	123	PL	Ati	"	1/45	36/68	12	124	-	1063	1502	As for Portion 79 (Nibok)

Any person who wishes to appeal against the distribution of this estate must lodge his or her appeal with the Supreme Court Registry within 21 days of this Gazette and no appeal may be commenced after that time.

Dated this 22nd day of November, 1972.

JEREMIA,
SECRETARY.

DECEASED ESTATES

The Nauru Lands Committee, having made all due enquiries hereby determines the following Deceased Estates and phosphate royalties as appears below.

District	Port No.	C.L. P.L.	Name of Land	Former Owner	Share	Gaz. No.	Land Vol.	Record Folio.	Royalties	N.P.C. No.	Admin. No.	Present Owners in equal shares		
Anabar	25	PL	Querang	Dagagi (dec'd)	1/8	51/61	2	26	-	-	-	Aigenoudi	1/8	
Uaboe	76	CL	Ewa	"	1/6	36/62	13	76	-	-	-	Aigenoudi	1/6	
Uaboe	92	CL	Itumuraro	"	1/6	41/62	13	92	-	-	-	As for Portion 76 (Uaboe)		
Uaboe	100	CL	Mwewewin	"	1/6	49/65	13	100	-	-	-	"	"	"
Baiti	189	PL	Betio	"	1/6	30/67	5	191	-	-	-	"	"	"
Baiti	203	PL	Eatetowak	"	1/6	54/67	5	205	-	-	-	"	"	"
Uaboe	139	PL	Anni	"	1/6	10/68	13	139	-	-	-	"	"	"
Uaboe	146	CL	Imwenom	"	1/6	36/68	13	146	-	-	-	"	"	"

Any person who wishes to appeal against the distribution of this estate must lodge his or her appeal with the Supreme Court Registry within 21 days of this Gazette and no appeal may be commenced after that time.

Dated this 22nd day of November, 1972.

JEREMIA,
SECRETARY.

G.N. No. 340/1972

DECEASED ESTATES

The Nauru Lands Committee, having made all due enquiries hereby determines the following Deceased Estates and phosphate royalties as appears below.

District	Port. No.	C.L. P.L.	Name of Land	Former Owner	Share	Gaz. No.	Land Vol.	Record Folio.	Royalties	N.P.C. No.	Admin. No.	Present Owner in equal shares		
Meneng	102	CL	Irebedi	Eipon Limen (dec'd)	1/3	21/47	11	104	-	-	-	John Willie	1/15	
												Gongauw Limen	1/15	
												Deijo Limen	1/15	
												Michael Imitsi	1/75	
												Rose Ann Imitsi	1/75	
												Cindy Imitsi	1/75	
												Cecilla Ann Imitsi	1/75	
												Eigudina Imitsi (LTO)	1/75	
												Lawrence Ebwade Stephan	1/60	
												Lilva Ebwade Stephen	1/60	
												May Patrick Cook	1/60	
												Pamela Andrew Tamakin	1/60	

4th December, 1972

Nauru

No. 53

G.N. No. 340/1972 (cont'd)

District	Port No.	C.L. P.L.	Name of Land	Former Owner	Share	Gaz. No.	Land Vol.	Record Folio.	Royalties	N.P.C. No.	Admin. No.	Present Owners in equal shares		
Yaren	270	PL	Atemarar	Eipon Limen (decd')	1/3	22/32	17	21	-	-	-	As for Portion 102 (Meneng)		
Yaren	307	PL	Ataningobwi	"	1/3	22/32	17	58	-	331	766	"	"	"
Yaren	313	PL	Atangawak	"	1/3	22/32	17	64	-	337	772	"	"	"
										826	1262			
										949	1388			
Boe	6	PL	-	"	1/3	28/57	6	16	-	144	564	"	"	"
										141	565			
										1215	1654			
Aiwo	159	CL	Atubwinarum	"	1/3	26/56	1	163	-	-	126	"	"	"
Meneng	96	CL	Irebedi	"	1/3	21/47	11	98	-	-	-	"	"	"
Aiwo	413	CL	Atubwinarum	"	1/3	44/60	15	167	-	-	-	"	"	"
Yaren	101	CL	Atemororo	"	1/3	28/62	14	102	-	-	-	"	"	"
Yaren	129	CL	Aningobwi	"	1/3	28/62	14	130	-	-	-	"	"	"
Yaren	331	PL	Atubwinumor	"	1/2	50/35	17	82	-	1264	828	John Willis		
										1091	656	Gongauw Limen		
												Deijo Limen		
												Michael Imitsi		
												Rose Ann Imitsi		
												Cindy Imitsi		
												Cecilia Ann Imitsi		
												Eigudina Imitsi (LTO)		
												Lilva Ebwade Stephen		
												Lawrence Ebwade Stephen		
												May Patrick Cook		
												Pamela Andrew Tamakin		
Meneng	267	PL	Atuwuro	"	1/3	27/32	18	19	-	621	1056	As for Portion 102 (Meneng)		

Any person who wishes to appeal against the distribution of this estate must lodge his or her appeal with the Supreme Court Registry within 21 days of this Gazette and no appeal may be commenced after that time.

Dated this 22nd day of November, 1972.

JEREMIA,
SECRETARY.

LAND DETERMINATION

The Nauru Lands Committee hereby determines the ownership of certain land or shares in land as being that shown below:-

District	Portion No.	C.L. P.L.	Name of Land	Reference	Former Owners	Shares	Present Owners in equal shares	
Anetan	94	CL	Otsinuwo	Gaz. 13/64	Victor E. Lily E. Ika Danang (dec'd)	1/6 1/6 1/3 1/3	Ika Lily Sammy Harris Victor Eoaso Gabwea Danang Babwaraga Danang Eikobwit Atsime Atsibwebweda Abouke (Est. of)...	1/3 1/6 1/6 1/12 1/12 1/12 1/12
Anetan	92	CL	Otsinuwo	Gaz. 13/64	Lawrence E. Lilva E. Eidienuae C. Pamela E.	1/4 1/4 1/4 1/4	Lawrence Ebwade Stephen Lilva Ebwade Stephen May Patrick Cook Pamela Nabwit Tamakin	1/4 1/4 1/4 1/4
Anetan	110	CL	Okoe or Ibwerin	Gaz. 29/64	Ujaoi T.	All	Ujaoi Tamakin	All
Ewa	3	CL	Mererawa	Gaz. 13/64	Lawrence E. Lilva E. Eidienuae C. Pamela E.	1/4 1/4 1/4 1/4	Lawrence Ebwade Stephen Lilva Ebwade Stephen May Patrick Cook Pamela Nabwit Tamakin	1/4 1/4 1/4 1/4
Ewa	137	CL	Anuer	Gaz. 13/64	Eidinijong Deraudag Romeo Addi Nylon Addi Vernier Addi Stanley Lupino Addi Verbena Agnes Eidanogoneida (Est. of) Denitage	1/12 1/12 1/12 1/12 1/12 1/12 1/12 1/12 1/2	Eidinijong Deraudag Romeo Addi Nylon Addi Vernier Andra-Dobuae Stanley Lupino Addi Verbena Agnes Eidanogoneida (Est. of) Denitage	1/12 1/12 1/12 1/12 1/12 1/12 1/12 1/12 1/2

Any person who wishes to appeal against these determinations must lodge his or her appeal with the Supreme Court Registry within 21 days of this gazette and no appeal may be commenced after that time.

Dated this 14th day of November, 1972.

JEREMIA,
SECRETARY.

LAND DETERMINATION

The Nauru Lands Committee hereby determines the ownership of certain land or shares in land as being that shown below:-

District	Portion No.	C.L. P.L.	Name of Land	Reference	Former Owners	Shares	Present Owners in equal shares
Ewa	58	PL	Paeduepe	Gaz. 39/70 43/69	George Daimon (dec'd)	1/7	Adeong Deireragea 1/252 Caleb Deireragea 1/252 Deinedo Deireragea 1/252 Beijedage Deireragea 1/252 Adioun Deireragea 1/252 Maein Deireragea 1/252 Susannah R. Capelle 1/168 Eidengarengar Tamakin 1/168 Frank Boiya 1/1008 (Lavinia Boiya 1/1008 (Drake Boiya 1/1008 Itsiwido T/ee. (Eibiaun Boiya 1/1008 (Moira Boiya 1/1008 (Itsiwido Boiya 1/1008 Walter Detsijogo 1/840 Soharab Detsijogo 1/840 Rustom Detsijogo 1/840 Janet Tangiro 1/840 Maura K. Thoma 1/840 Lawrence Ebwade Stephen 1/168 Lilva Ebwade Stephen 1/168 May Patrick Cook 1/168 Pamela Andrew Tamakin 1/168 Renzo Paul 1/42 Hammer DeRoburt 1/84 Dagadaube Ika 1/252 Deinauwea Ika 1/252 Idarabwe Ika (LTO) 1/252 Deireragea (dec'd) 1/7 Adeong Deireragea 1/42 Caleb Deireragea 1/42 Deinedo Deireragea 1/42 Beijedage Deireragea 1/42 Adioun Deireragea 1/42 Maein Deireragea 1/42

4th December, 1972.

Nauru

No. 53

G.N. No. 342/1972 (cont'd)

District	Portion No.	C.L. P.L.	Name of Land	Reference	Former Owners	Shares	Present Owners in equal shares
					Eirereitag (dec'd)	1/7	Dagadaube Ika 1/42 Deinauwea Ika 1/42 Idarabwe Ika (LTO) 1/42 Lawrence Ebwade Stephen 1/56 Lilva Ebwade Stephen 1/56 May Patrick Cook 1/56 Pamela Andrew Tamakin 1/56
					Timothy Daimon (dec'd)	1/7	Susannah R. Capelle 1/28 Eidengarengar Tamakin 1/28 Frank Boiya 1/168 (Lavinia Boiya 1/168 (Moira Boiya 1/168 (Drake Boiya 1/168 (Eibiaun Boiya 1/168 Itsiwido Boiya (LTO) 1/168 Walter Detsijogo 1/140 Soharab Detsijogo 1/140 Rustom Detsijogo 1/140 Janet Tangiro 1/140 Maura K. Thoma 1/140
					Derimea (dec'd)	1/7	Lawrence Ebwade Stephen 1/28 Lilva Ebwade Stephen 1/28 May Patrick Cook 1/28 Pamela Andrew Tamakin 1/28
					Paul Daimon (dec'd)	1/7	Renzo Paul 1/7
					Hammer DeRoburt	1/14	Hammer DeRoburt 1/14
					Eijaro (dec'd)	1/14	Dagadaube Ika 1/42 Deinauwea Ika 1/42 Idarabwe Ika (LTO) 1/42

Any person who wishes to appeal against this determination must lodge his or her appeal with the Supreme Court Registry within 21 days of this Gazette and no appeal may be commenced after that time.

Dated this 22nd day of November, 1972.

JEREMIA,
SECRETARY.

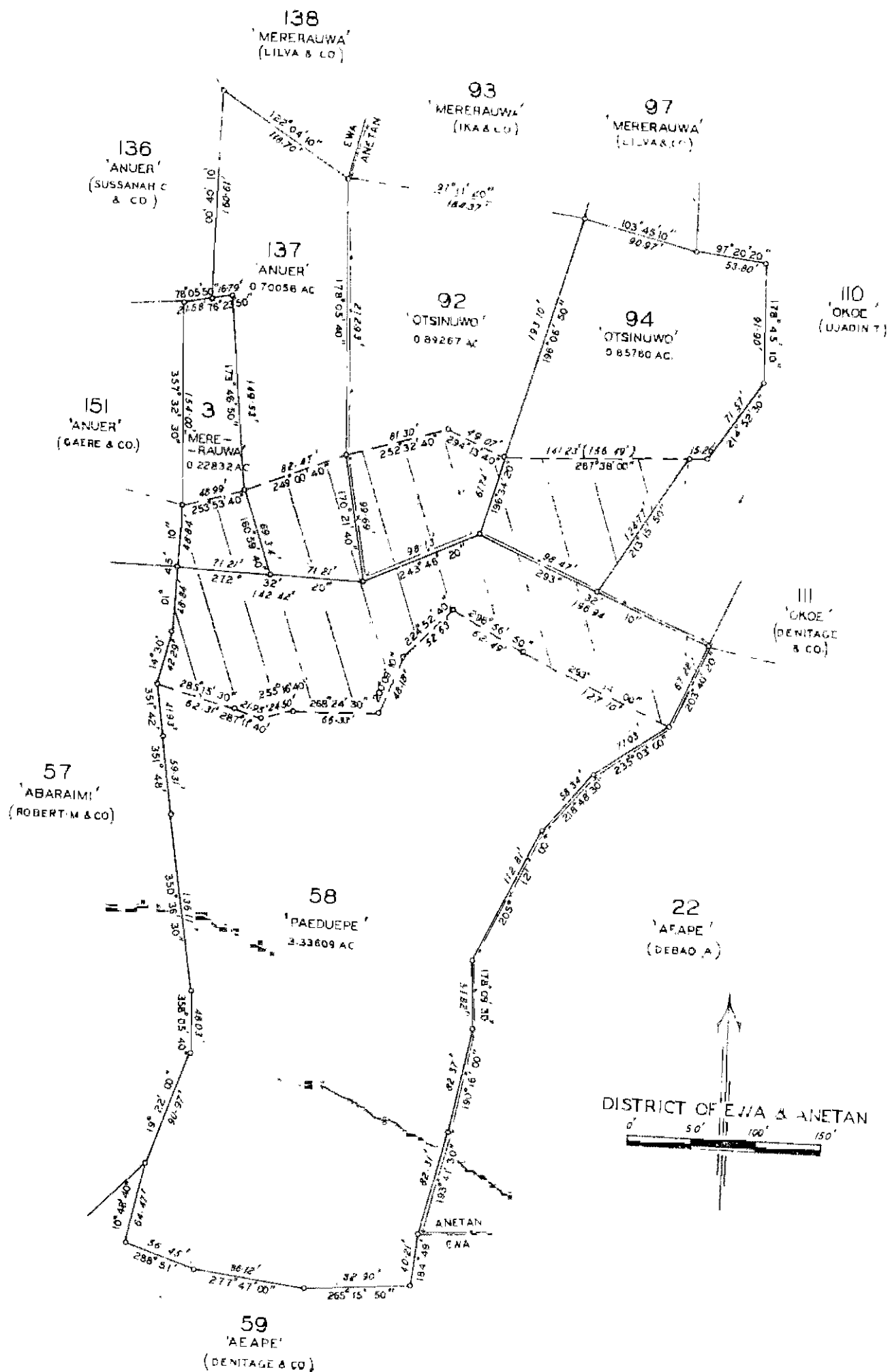



97

'MERERAUVIA'
(LILYAS & CO.)

110

"OKOE"
OR
"JEWERIN"

0.84304 AC.

111

' OKOE '
(DENITAGE & CO.)

94

'OTSINUWO'
(IKA & CO.)

58

'PAEDUE PE'
(RENTO & CO.)

22

'AEAPE'
(DEBAO A)

UNDETERMINED LAND

G. N. NO. 336/72
PAGE. 2.

DISTRICT OF ANETAN.



25

"BOTIBAB"
(DEBAO-A & CO.)

127

"BOTIBAB"
1.00557 AC.

28

"BOTIBAB"
(EIDUGUNEIDA G.
& CO.)

29

"ATOUWUDUA"
(IKA & CO.)

